

SHR SERIES

APPLICATION FLEXIBILITY WITHIN REACH

Crown's walkie reach stacker offers the flexibility and versatility to meet a number of application challenges. The SHR provides an efficient solution for working in tight areas and handling random pallet sizes.

The SHR 5500 is engineered and designed for **superior performance** and **long-lasting value** in the toughest applications.



Discover how the SHR 5500 Series improves load handling in tight spaces:

Built Tough

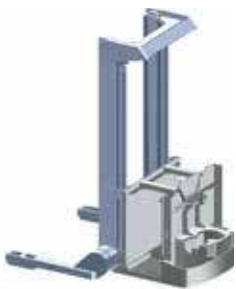

Built to outlast and outperform other brands, the SHR Series features a powerful AC traction motor, heavy-duty frame and mast, steel power unit doors, and a die-cast aluminum handle.

Clear View



Industry-leading visibility is the result of a low-profile power unit, exclusive reach-carriage design, high-visibility mast and a center-mounted control handle.

Take Control



Crown's innovative X10® handle simplifies the operation of controls and reduces fatigue. The operator can quickly switch between two pre-programmed performance levels.

Maneuver With Ease



Electronic power steering minimizes steering effort and reduces fatigue, while the brake override feature facilitates operation with the handle in a nearly vertical position.

Performance Advantage



Crown's intelligent Access 1 2 3® Comprehensive System Control enables safe, optimized truck performance and advanced diagnostics.

Choose Crown's SHR 5500 Series for **intelligent performance** and **long-term value**.

Contact your local Crown dealer today.